

## Electrofusion Saddles for large diameter pipes



### Saddles PN16

Plasson Saddles are designed according to the specific needs of end users, keeping in mind the field conditions and limitations, ensuring a simple installation which will be safe and secure.

Plasson Saddles have a large fusion zone which exceeds the requirements of the various international standards resulting in considerably greater robustness and reliability of the fusion joint.

Plasson's innovative clamping tool is designed in a way that guarantees the complete saddle welding surface is in direct contact with the pipe even when the pipe is oval.

Full bore outlet SDR11 - 90, 110, 125 and 160mm

Universal - two saddles cover the complete range of pipes from 250 to 800mm, with two branch options, spigot or flanged (NP10/16).

Features	Benefits
Large Fusion Area	<ul style="list-style-type: none"> <li>High resistance to hydraulic forces</li> <li>Strong and uniform welding performance</li> <li>Long term joint integrity</li> </ul>
Embedded heated coil	<ul style="list-style-type: none"> <li>No need for preheating process</li> <li>Eliminates the risk of physical damage to the wire</li> <li>Coils protected from corrosion build-up during storage</li> <li>Instant heat transfer between coil and PE</li> </ul>
SmartFuse system	<ul style="list-style-type: none"> <li>Ensures fast and easy welding process</li> <li>Full traceability of fitting and components to ensure quality control</li> </ul>
Special test port	<ul style="list-style-type: none"> <li>Enables pressure test of weld before cutting into the pipe</li> </ul>
Dedicated clamping tool	<ul style="list-style-type: none"> <li>Guarantees the complete saddle welding surface is in direct contact with the pipe even when the pipe is oval.</li> </ul>

### Technical Information

- Fittings material: PE100
- PN16 saddles suitable for pipe wall thickness SDR 11 to 26
- Electrofusion parameters obtained from barcode or input manually
- Plasson's internal standards are based upon EN 1555, EN 12201, AFNOR NFT 54-066, AS/NZS 4129
- Suitable pipes: PE80, PE100, PEX-A
- May be welded at ambient temperatures: -10°C to +45°C

**Plasson UK Ltd**, Plasson House, 27 Albert Drive, Burgess Hill, West Sussex. RH15 9TN | Tel: 01444 244446

Global Presence - Local Commitment

# Spigot Saddle and Flanged Saddle

**495804 EF Branch Saddle (multi-size)**  
250/280 - 400mm  
450 - 800mm

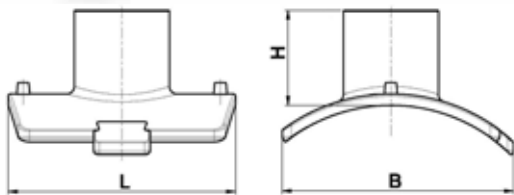

Product	d x d1	B	H	L
495804400090T	250-400 x 90mm	305	102	300
495804400110T	250-400 x 110mm	305	104	300
495804400125T	250-400 x 125mm	305	125	300
495804400160T	<b>280</b> -400 x 160mm	305	119	300
495804710090T	450-800 x 90mm	315	105	300
495804710110T	450-800 x 110mm	315	105	300
495804710125T	450-800 x 125mm	315	109	300
495804710160T	450-800 x 160mm	315	115	300

**495904 EF Flanged Branch Saddle (multi-size)**  
250/280 - 400mm  
450 - 800mm

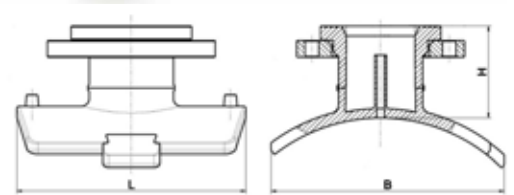

Product	d x d1	B	H	L
495904400080T	250-400 x 80mm/3"	305	115	300
495904400100T	250-400 x 100mm/4"	305	121	300
495904400150T	<b>280</b> -400 x 150mm/6"	305	132	300
495904710080T	450-800 x 80mm/3"	315	117	300
495904710100T	450-800 x 100mm/4"	315	123	300
495904710150T	450-800 x 150mm/6"	315	132	300

## Saddle Clamp and Scraper

**Important:** Saddle Clamp and scraper **MUST** be used to install saddle correctly  
Available to buy or to hire



**Plasson UK Ltd**, Plasson House, 27 Albert Drive, Burgess Hill, West Sussex. RH15 9TN | Tel: 01444 244446

Global Presence - Local Commitment

[www.plasson.co.uk](http://www.plasson.co.uk)

**PLASSON**<sup>®</sup>**UK**